

PreAmp

5 band



BOOSTING MOBILE SIGNAL ACROSS LONG CABLE RUNS

800/900/1800/2100/2600Mhz

Do not use Stella Doradus products with non stella doradus equipment.

Stelladoradus products operate silently on the operators network. By using our equipment with competitors equipment you break this control system and could potentially harm the operators network. Doing so will void warranty.

PreAmp

5 band

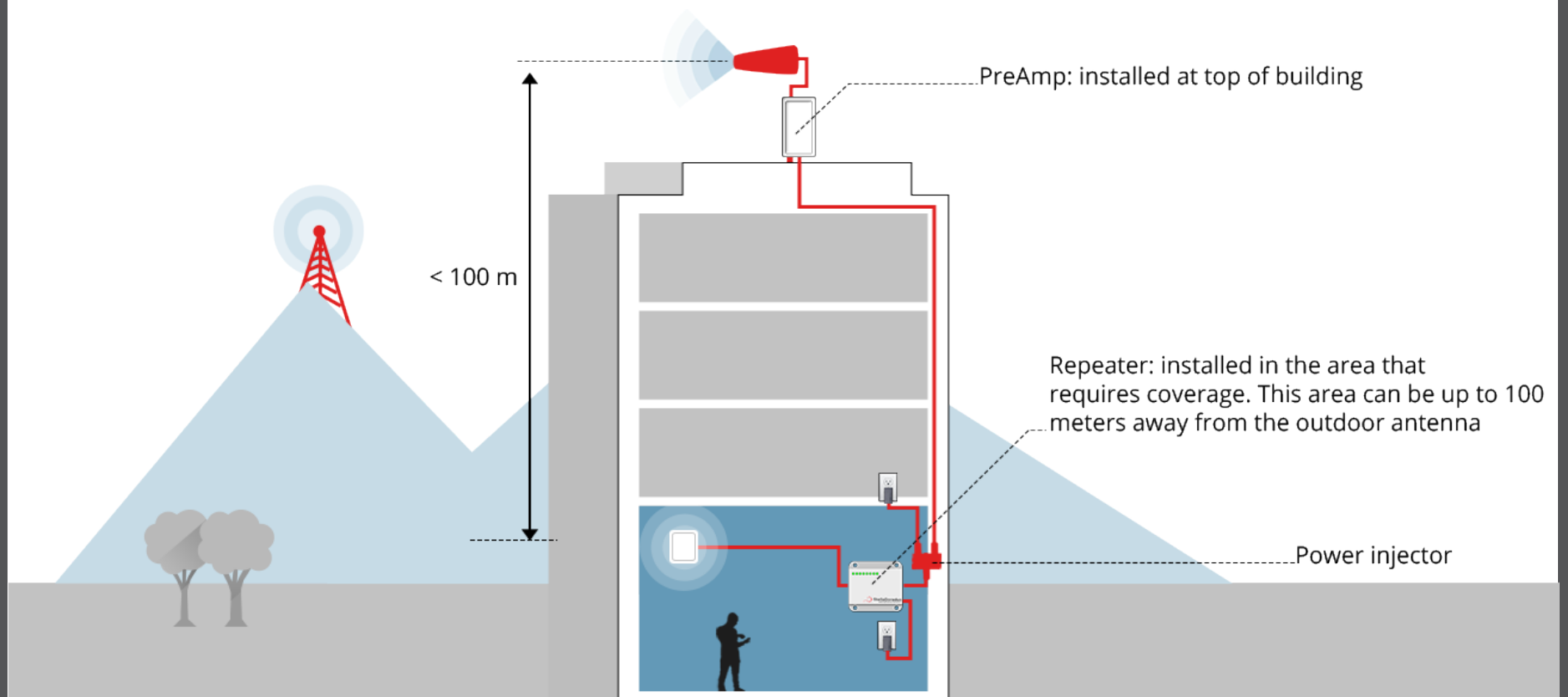

The pre-amp is installed close to the outdoor antenna to give your mobile signal that extra boost for long cable runs. You can attach a cable 100 meters long after the preamp! You can then connect directly to a machine (M2M) OR install a repeater. A repeater will give you ~5 room coverage.

The Power injector sends power up to the pre-amp which is installed outside, usually on the pole under the antenna.

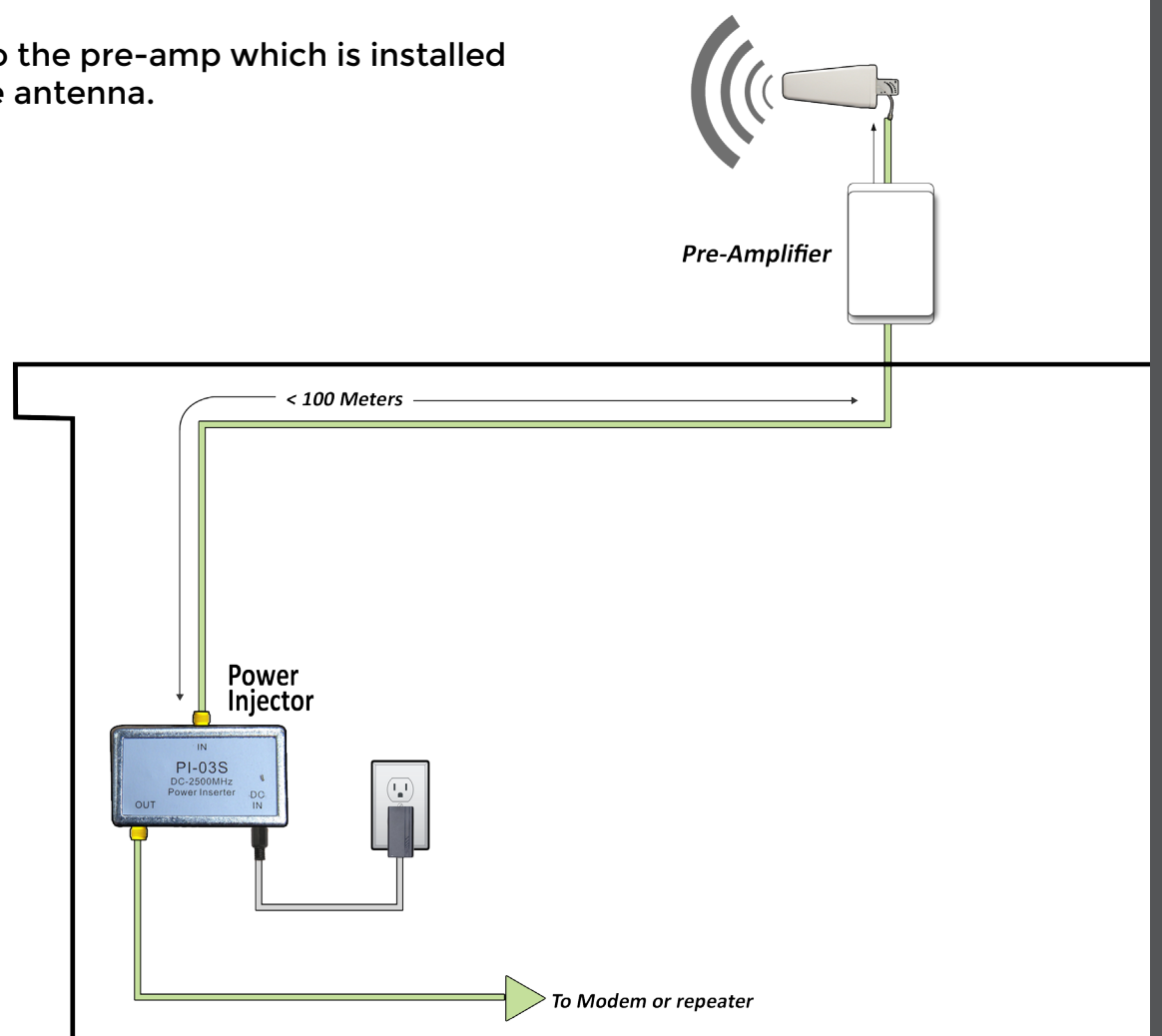

PreAmp

5 band



- Model number: SD-PA-LGDWH
- Frequency: 800/900/1800/2100/2600

Frequency Specifications:

Frequency bands(Mhz):	(791 - 862MHz)+(880-960MHz)+(1710-1880MHz)+(1.92-2.17GHz)+(2500-2690MHz)	
Gain:	Uplink Gp > 20dB	Downlink Gp> 25dB
Pass band ripple:	< 2dB	
I/O impedance:	50 ohm/SMA female connector	
Max uplink/downlink signal strength:	18dBm / -35dBm	
Ambient Temperature:	-30°C to +70°C	
Power supply input:	110 - 240V AC	
Power supply output:	12v DC	
Oscillation Control	Automatic	
Level Control:	Automatic*	
Uplink Switch Off	Yes**	
AGC Range	30db	
Surge protection	SMA connectors DC grounded, 12V DC port MOV protected	

Power Supply Specification:

AC	100-240V	50-60Hz
DC input	12V	3A
Typical power usage	20W	

Mechanical Specification:

Length	35cm
Width	30cm
Depth	4.3cm
Weight	2kg
Mounting	4 x 5mm holes for mounting
Windage	(at 215kmph) 28g
Mechanical tilt	0-25 degree
Mounting Pipe	5cm pipe
Materials - Radome	UV stabilized polystyrene white
Clamps	HDC stell + galvanised bolts

* Automatically adjusts during installation. Thereafter, automatically adjusts for seasonal variation in pathloss between Base station and Outdoor Antenna.

** The uplink amplifiers switch off when the preamp is not in use, thus reducing the uplink noise to almost zero. When the preamp is in use (eg phone call being made), the uplink amplifier switches on for the duration of the call and a blue LED switches on indicating this is the case.

Note: Specifications subject to change without notice.